

MARION TOWNSHIP FRACTION 06 R12 TWP 8
MORGAN COUNTY, OH

CREWS ADDITION TO CHESTERHILL

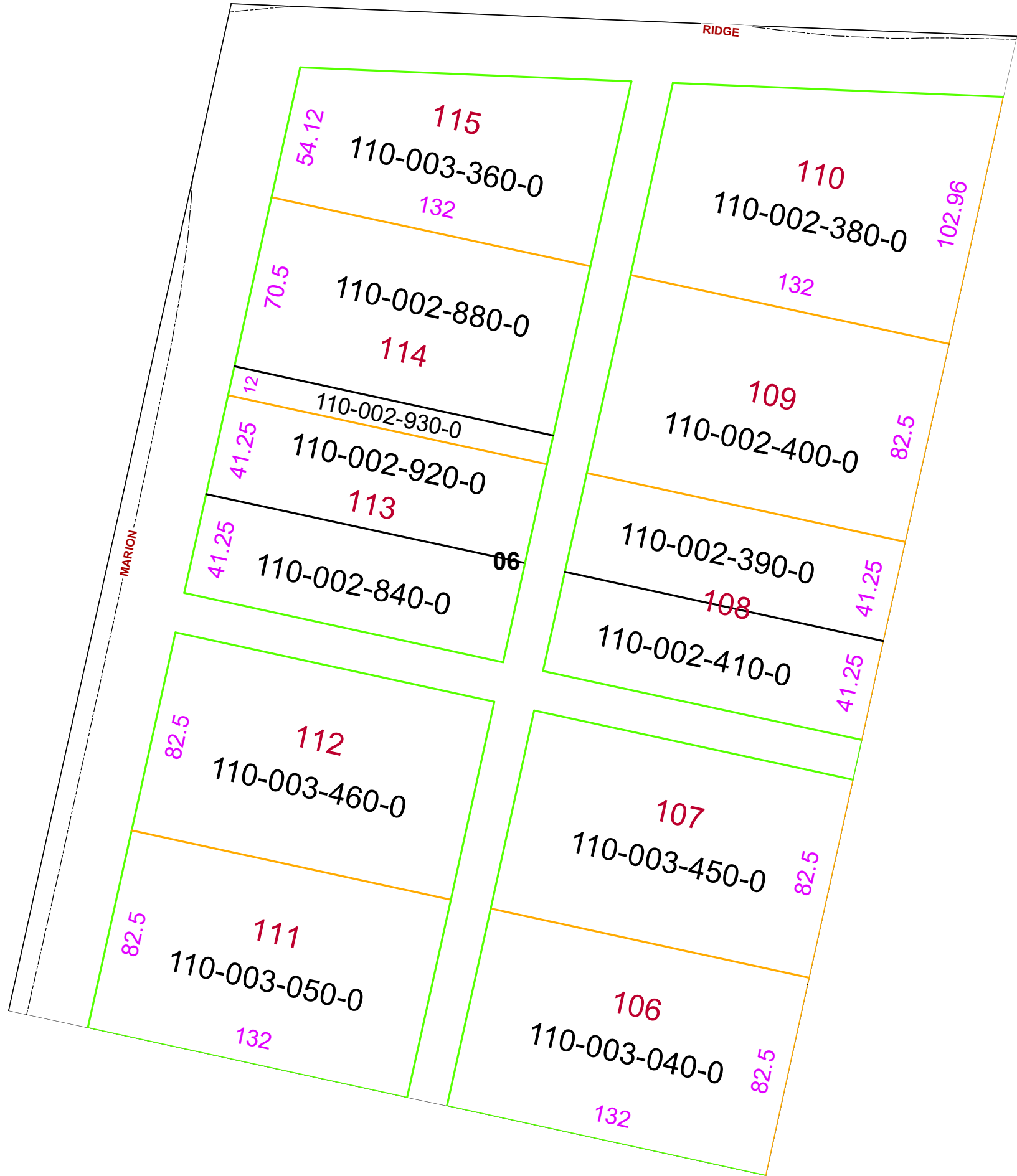

PIN	Owner	VOL	PAGE	LegalDescr	Acres
110-003-040-0	DENNIS ALAN LLOYD & KIMBERLY DAWN	OR225	3147	INLOT 106 CREWS ADDITION	0
110-003-360-0	FOSTER DAVID A	OR147	769	INLOT 115 CREWS ADDITION	0
110-003-450-0	HOPSTETTER STEPHEN	OR207	2989	INLOT 107 CREWS ADDITION	0
110-002-410-0	HOPSTETTER STEPHEN & TAMMIE	OR12	83	INLOT 108 CREWS ADDITION	0
110-002-390-0	HOPSTETTER STEPHEN & TAMMIE	OR12	83	INLOT 108 CREWS ADDITION	0
110-002-400-0	HOPSTETTER STEPHEN & TAMMIE	OR12	83	INLOT 109 CREWS ADDITION	0
110-002-380-0	HOPSTETTER STEPHEN & TAMMIE	OR12	83	INLOT 110 CREWS ADDITION	0
110-002-840-0	IRVIN PATRICK J & DAISY O	OR94	306	INLOT 113 SURVIVORSHIP C	0
110-003-460-0	MAYLE HEATHER D	OR204	927	INLOT 112 CREWS ADDITION	0
110-003-050-0	RIFFLE ANDREW MICHAEL	OR228	2906	INLOT 111 CREWS ADDITION	0
110-002-920-0	SHOOK GARY L & JANICE SUE	OR230	2576	INLOT 113-SURVIVORSHIP C	0
110-002-930-0	SHOOK GARY L & JANICE SUE	OR230	2576	INLOT 114-SURVIVORSHIP C	0
110-002-880-0	SHOOK GARY L & JANICE SUE	OR230	2576	INLOT 114 - SURVIVORSHIP	0

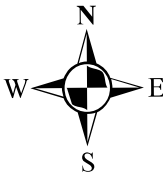

Boundaries	
----- Hidden	----- ROW
----- Hydro	----- Section
----- Roads	----- Lot
----- County	----- Township
----- Parcel	----- Parcels

